

Aluminium Composite Panel



Aluminium Composite Panel
Sign & Display Panel
Aluminium Honeycomb Panel

Processing Methods

Maxbond Aluminium Composite panels can be shaped with ordinary aluminum processing and woodworking machines and tools:

(1) Saw cutting

Circular saws and vertical saws for woodworking can cut Maxbond panels easily. We recommend the carbide tip blade made for aluminum and plastic.

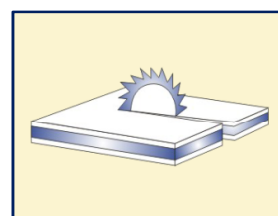

(2) Shearing

A square shear is the most efficient method for sizing a large quantity of panels. Some shear droop may occur at the cut edge.

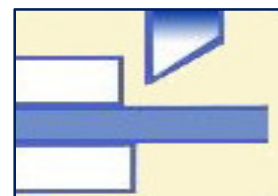

(3) Welding

Maxbond can be joined by welding the core with the help of hot jet gun.

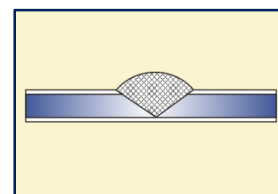

(4) Punching

Maxbond can be punched by conventional sheet metal punching machines or manual punches according to the drawing.

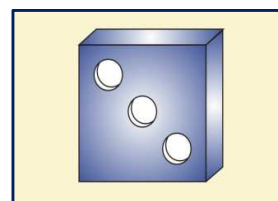

Processing Methods

(5) Curving & Bending

Running saws and panel saws for woodworking can cut Maxbond panels easily. We recommend the carbide tip blade made for aluminum and plastic.



(6) Folding

After grooving, Maxbond Panels can be easily folded and shaped by various routing techniques.

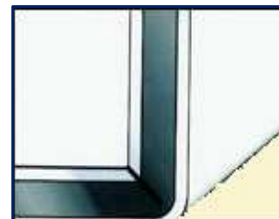

(7) Printing

Excellent compatibility with any silk-screening process. All surfaces must be free from all dirt.

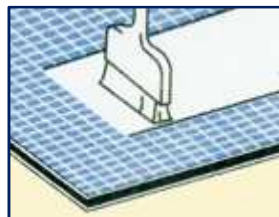

(8) Drilling

Maxbond panels can be drilled with twist drills which are normally used for aluminium and plastics on machines common for metals.

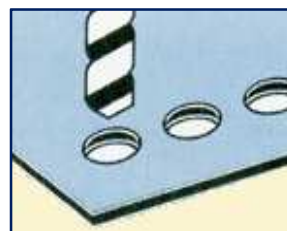

Processing Methods

(9) Routing & Grooving

It is important to leave 0.2 to 0.4mm of core material in U-grooving: namely, the remaining thickness becomes 0.7 to 0.9mm. A carbide tip should be used and we recommend 110° of a grooving angle for 90° bends. Panel saw or NC router is suitable for mass grooving production.



There are 3 common routing & grooving options.

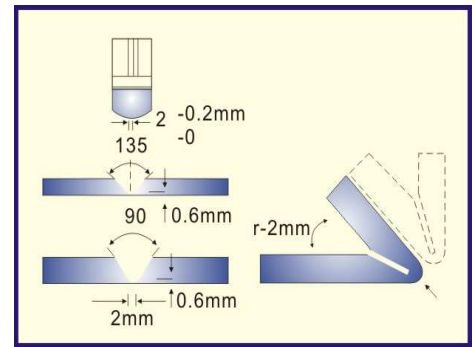
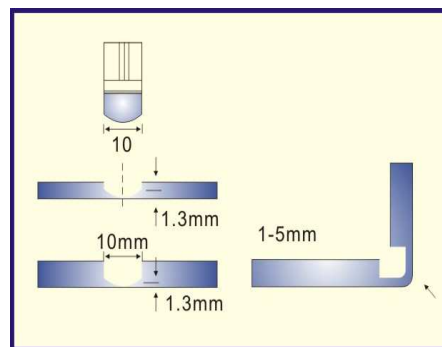
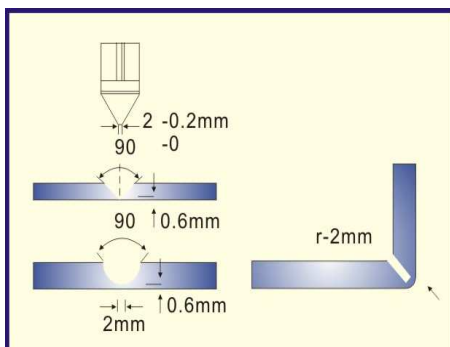

Installation Guide

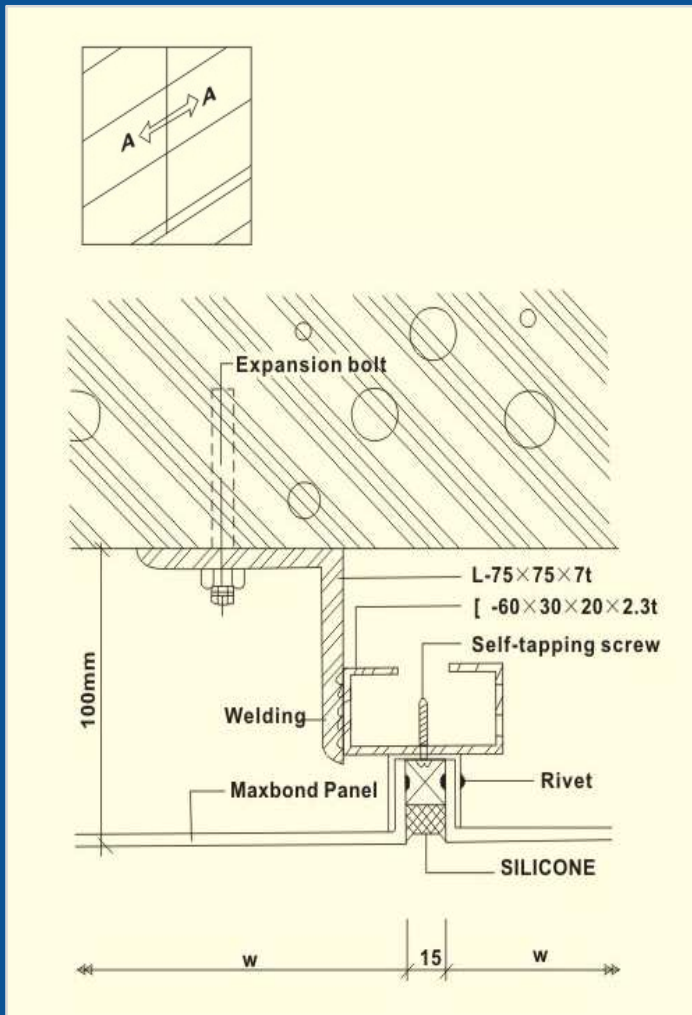

Horizontal Section

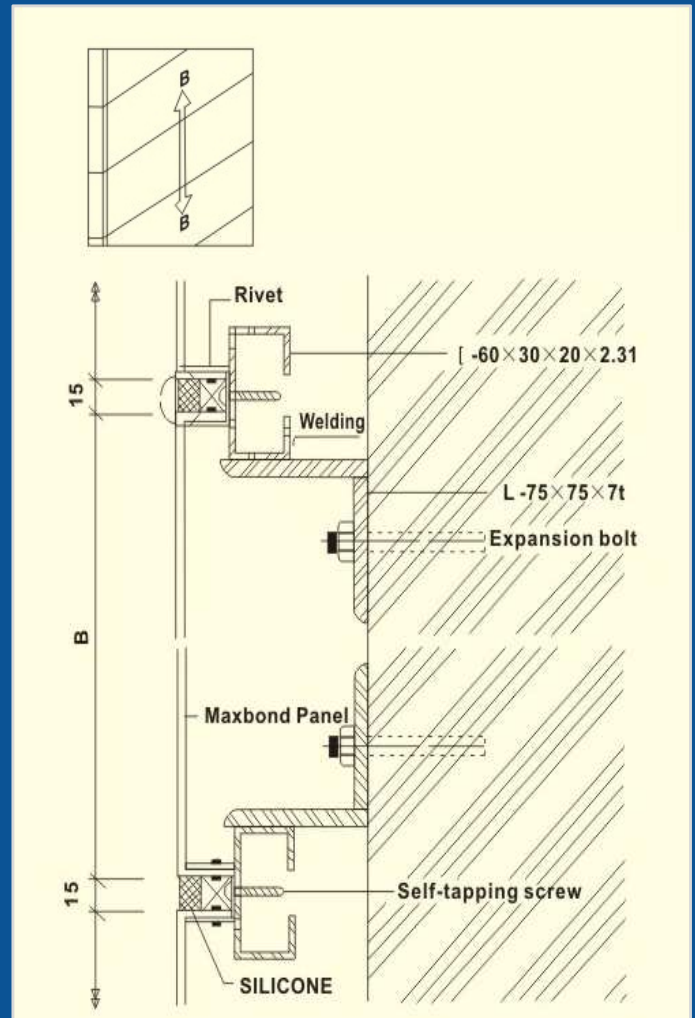

Vertical Section

Installation Guide

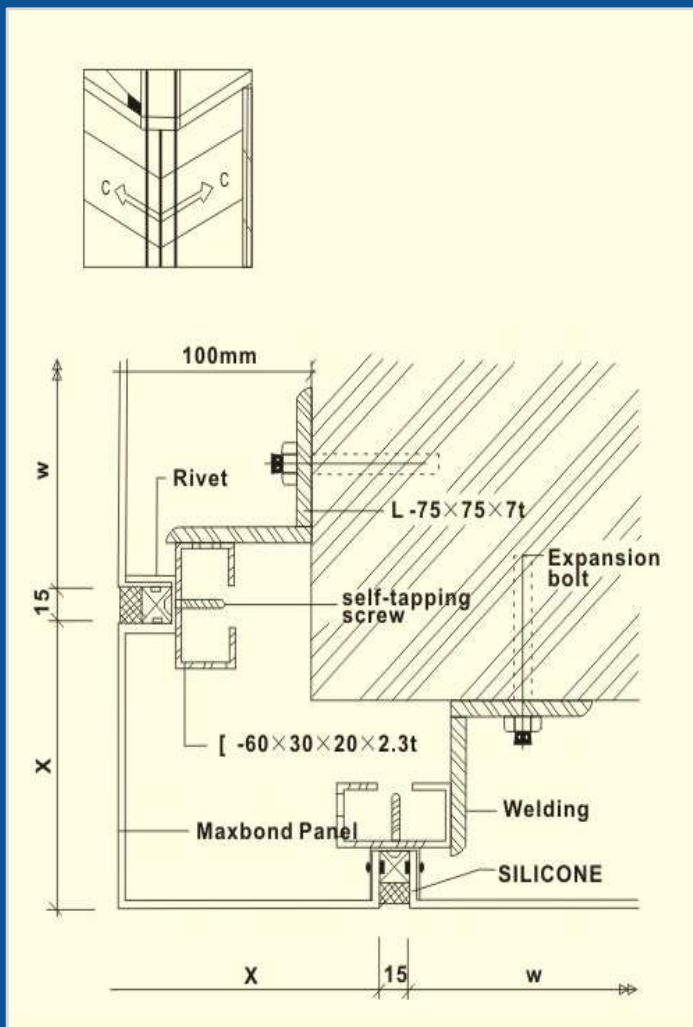

External Angle Plan Section

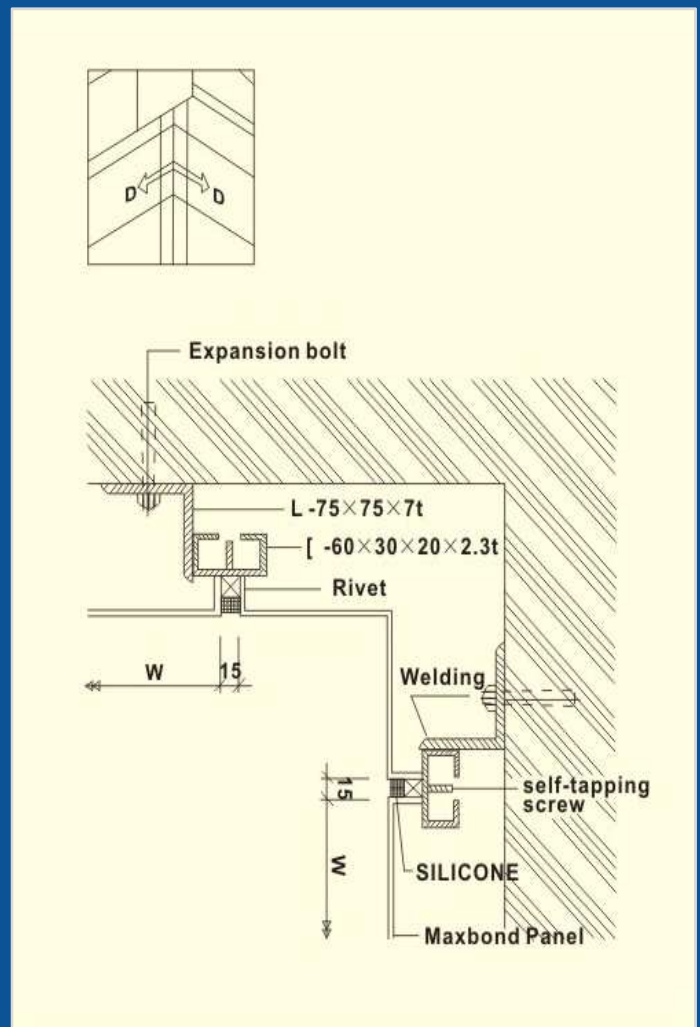

Internal Angle Plan Section

Installation Guide

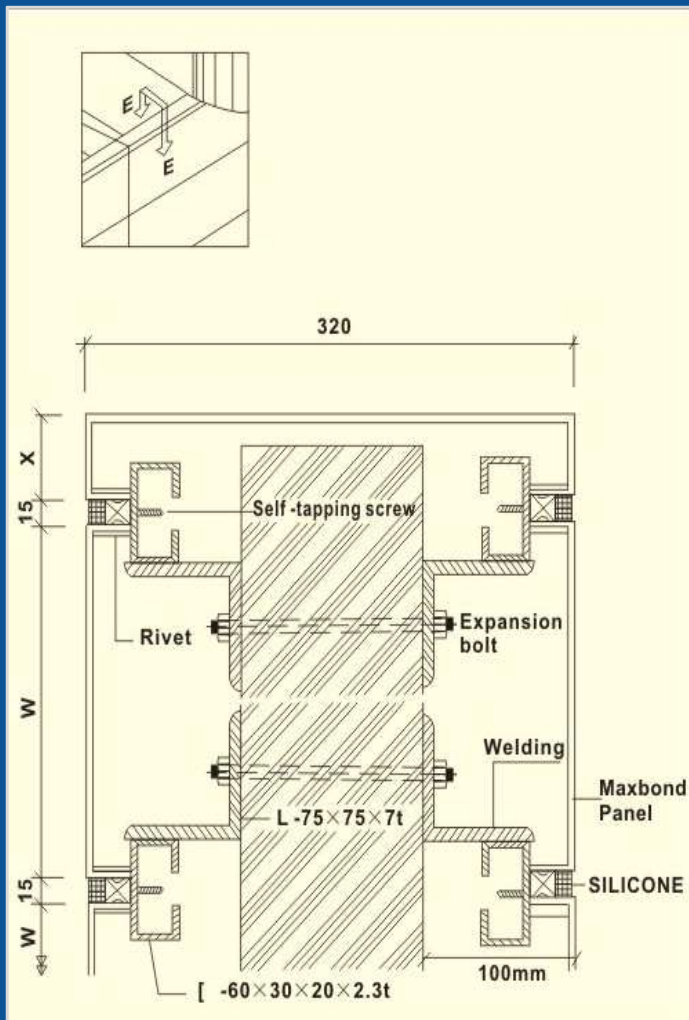

Paraper Vertical Section

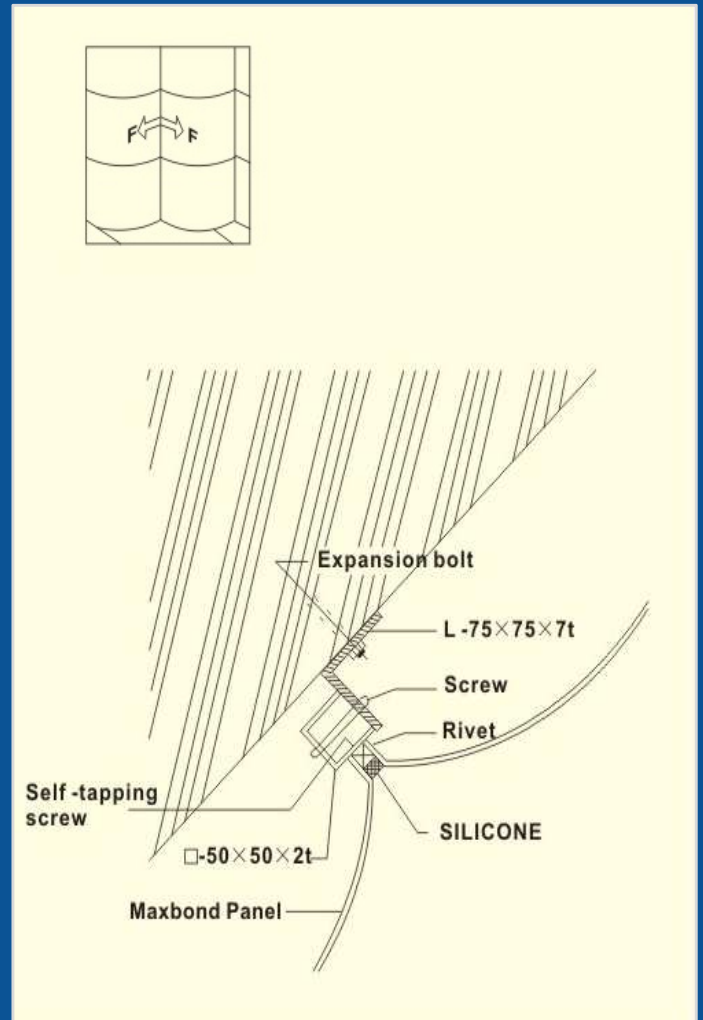

F-F Plan Section

Installation Guide

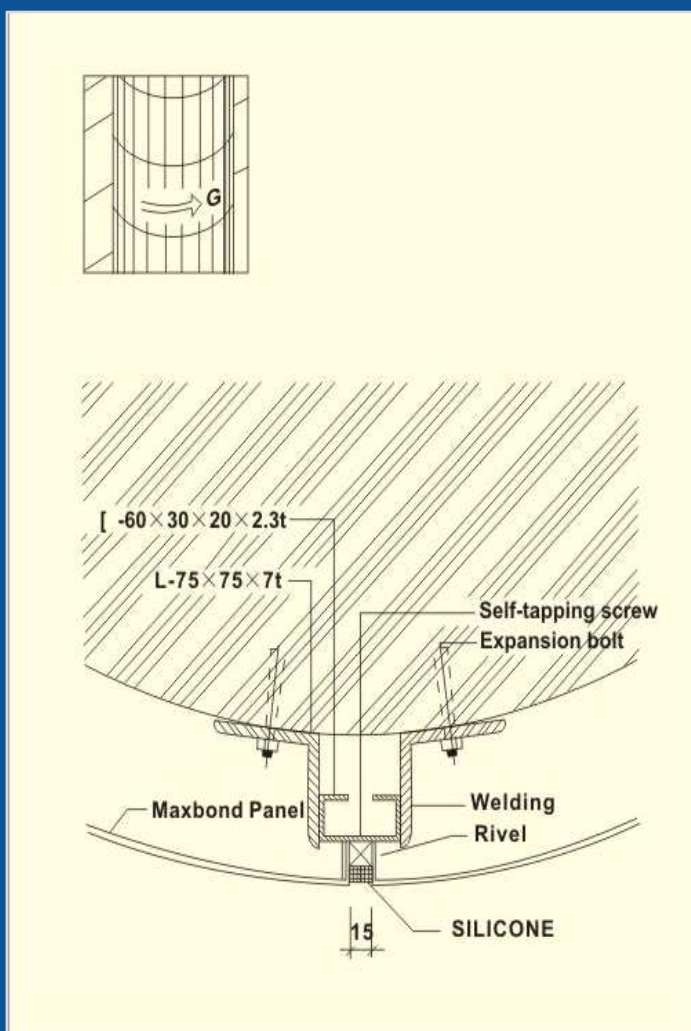

Circular Section

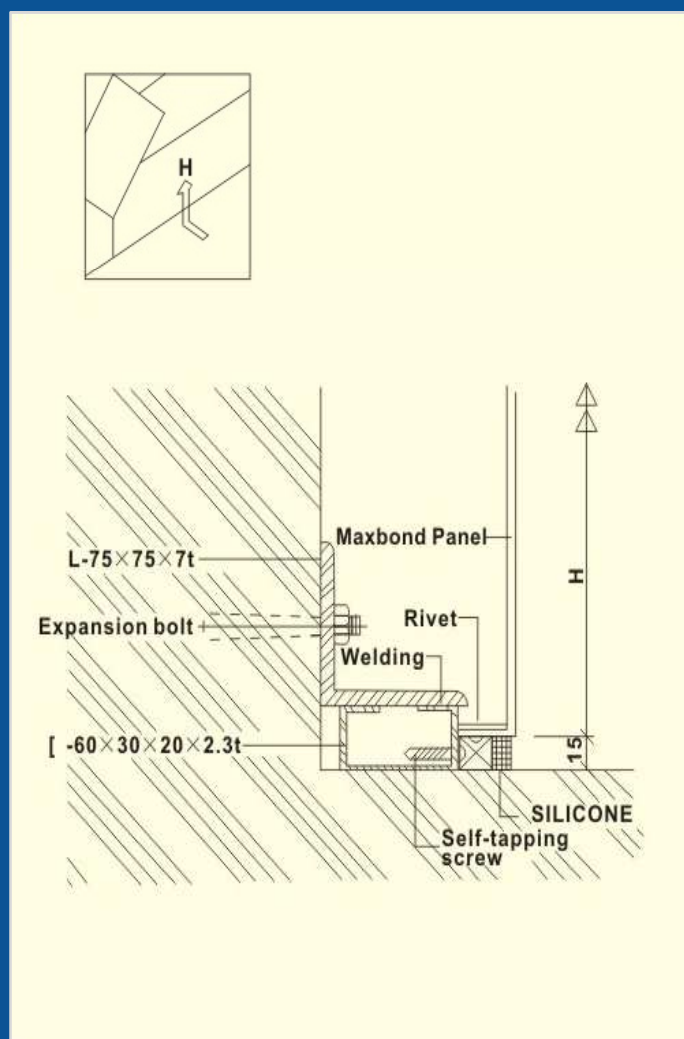

H-H Plan Section

Maxchance International Co., Ltd.

Maxbond International Co., Ltd.

Add.: 11F-1, No. 177, Yungji Road, Taipei,
Taiwan

TEL: +886-2-27486233

FAX: +886-2-87870998

Email: info@maxchancetw.com

Website: <http://www.maxbond.com.tw>